

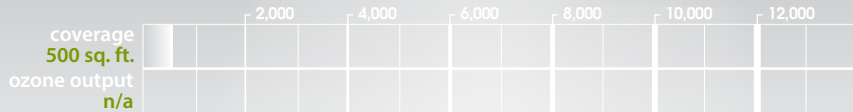

AP 500



2017 Space Technology Hall of Fame Inductee



SINGLE ROOM AIR SYSTEM

## description

- Compact, natural air treatment system – not a filter
- Plugs into existing 120 volt outlet
- No wiring required
- No cleaning required
- Anti-theft mounting arrangement

## applications

- Small or isolated indoor pollution and odor causing areas
- Waiting rooms or small lobbies
- Hotel rooms
- Nursing home rooms
- Public restrooms

## the technology

Powerful and inconspicuous, the AP 500 system is designed to target larger rooms with ActivePure®. The AP 500 works as a stand-alone unit or as companion to the AP3000 or INDUCT units for more complete treatment. An anti-theft mounting option makes it perfect for offices, restrooms, and other moderate sized areas up to 500 square feet.

AP 500 utilizes ActivePure® Technology to effectively treat interior air and exposed surfaces. A standard 120VAC outlet on the side of the unit allows for mounting over an existing wall outlet without inconvenience. Includes a removable, washable lint screen.

Published scientific studies conducted at Kansas State University demonstrated that ActivePure® Technology substantially reduces microbial populations on surfaces. The study's results have not been reviewed by the FDA, EPA or any other governmental agency. Our products are not medical devices and are not intended to diagnose, treat, or cure any disease.



## specifications

<b>AP 500</b>	<b>00693</b> <i>NOTE: This unit does not meet California requirements and cannot be shipped to California.</i>	
<b>electrical</b>	120V~, 60 Hz, .18 amp	13 watts* power consumption
<b>mechanical</b>	one control switch	on/off
<b>dimensions</b>	6"W x 12"H x 4"D	15.24cm W x 30cm H x 10cm D
<b>weight</b>	2.9 pounds	1.3 kilograms

\*Our products are not medical devices and are not intended to diagnose, treat, or cure any disease. We make no claims and no claims should be inferred as to the efficacy of our products to sanitize, disinfect or kill germs or other antimicrobials.

A powerful but inconspicuous air freshener system that can be plugged into any standard electrical outlet and treats up to a 500 sq. ft. area.

## applications list

- Waiting rooms or small lobbies
- Hotel rooms
- Dorm rooms
- School classrooms
- Public restrooms
- Nursing home rooms
- Offices

## installation details

1. Locate a grounded outlet with proper clearances. It is not recommended to use a GFCI (Ground Fault Circuit Interrupter) equipped outlet.
2. Remove the center cap of the AP 500 by inserting a small blade under the cap edge and lift up.
3. Remove the screw from outlet faceplate (Leave faceplate on outlet).
4. Insert AP 500 into outlet and secure from the front through the attachment hole with screw provided.

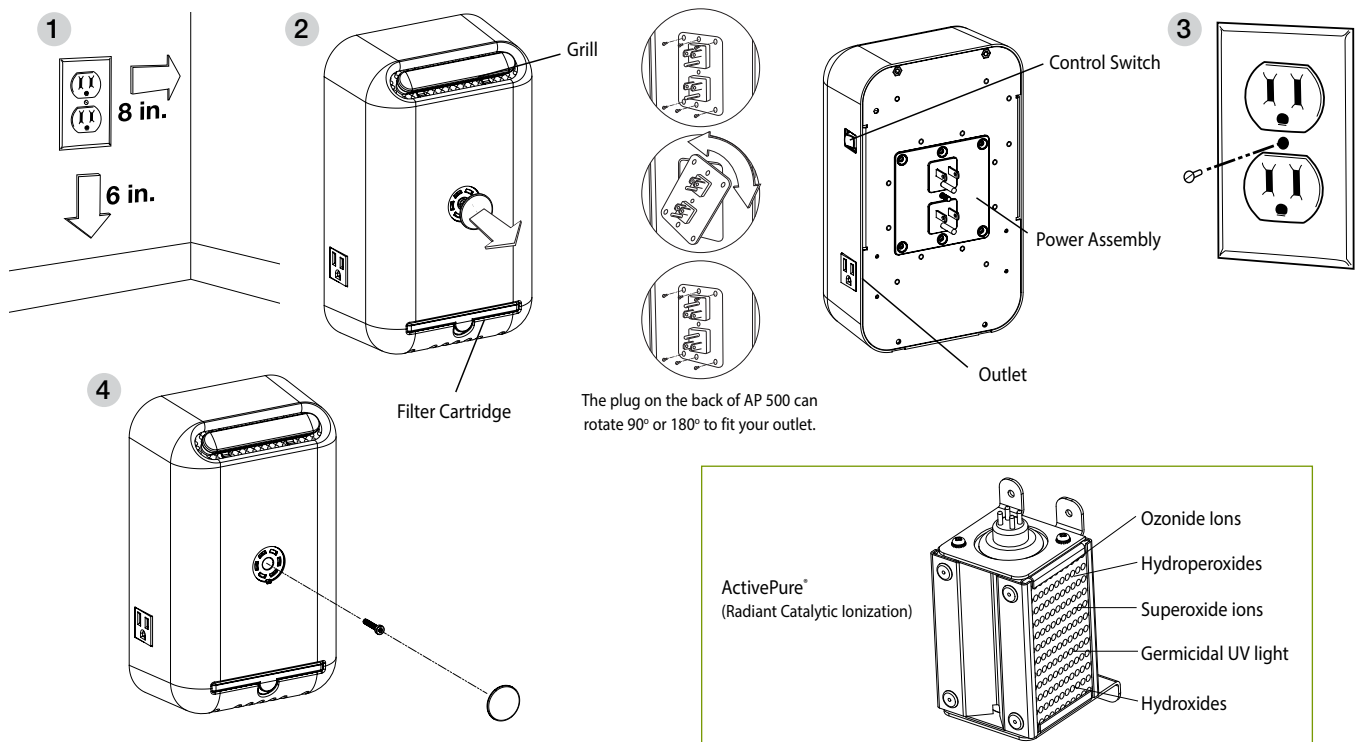

Distributed By: